



The directly submersible motor  
for any underwater application

## Goldline S-Series

Submersible Motors



Goldline S-Series motors operate reliably through a long service life without the need to add special enclosures or seals. They are the high-performance, low-maintenance choice for everything from theme-park submarines to inspection of nuclear reactor cooling tanks, mineral exploration on the sea floor, wastewater treatment, industrial irrigation and many other uses.

### Operate at depths up to 20,000 feet under the sea

- **Any application, shallow or deep.** Oil-filled, pressure-compensated brushless servo motors operate at underwater pressures up to 10,000 psi, depending on specified connectors.
- **Rugged performance.** Stainless steel and aluminum nickel bronze alloy housings with specialized shaft, seals, bearings and connectors withstand deep-sea pressures, shocks and corrosives.
- **Superior vehicle control.** Smooth, fast acceleration provides exceptional underwater maneuverability. Reduced EMI and RFI helps maintain integrity of remote-control, video and audio signals.

### Maximize operating times

- **Highly efficient.** Permanent-magnet motor maximizes battery life or allows for a smaller umbilical cable in ROV applications.
- **High thermal efficiency.** A high ratio of output power to frame size enables use of a smaller, lighter motor.
- **Long life with minimal maintenance.** With a brushless design, the durable bearings and seals are the only contact parts subject to wear. O-ring seals are externally serviceable.

Australian Distributor for Kollmorgen



hello@motion-werkz.com  
www.motion-werkz.com  
Call us: 0499 885 772

# Goldline S-Series

## Submersible Motors

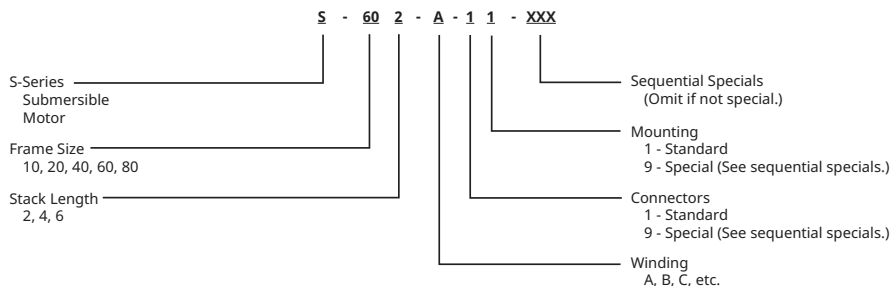
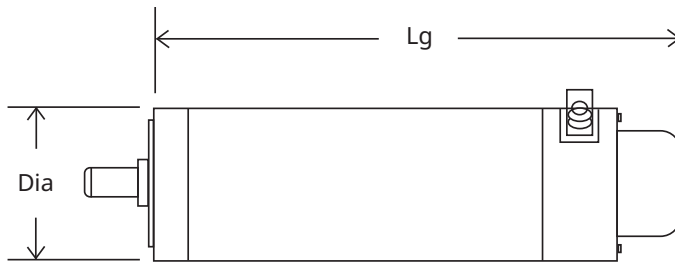

PERFORMANCE DATA - 240VAC (320VDC) Rated												
Motor Model	Cont. Torque (stall) @40C Amb., Nm	Cont. Current, Arms	Peak Torque, Nm	Peak Current, Arms	Torque Constant, Nm/Arms	Back EMF Constant, Vrms/krpm	Resistance @25C, Ohms	Inductance (line-to-line), mH	Rotor Inertia, kg-m <sup>2</sup>	Dia (in)	Lg (in)	Weight (kg)
S-102-A*	1.68	4.86	2.4	7.0	0.35	20.91	6.8	30	3.10E-05	3.24	8.76	2.5
S-104-A**	3.09	6	4.38	9.0	0.512	31.0	5.3	28.1	4.61E-05	3.24	9.87	3.2
S-106-A***	4.39	6.1	6.18	9.0	0.723	43.7	6.5	37.5	7.65E-05	3.24	11.07	8.6

\*Ratings assume water-cooling, continuously moving, 1 Liter/min. at 25C Water Temperature  
 \*\*Ratings assume water-cooling, continuously moving, 3 Liters/min. at 25C Water Temperature  
 \*\*\*Ratings assume water-cooling, continuously moving, 3 Liters/min. at 22C Water Temperature

S-202-A*	4.49	3.4	7.46	6.0	1.31	79.5	17.7	185	9.97E-05	4.24	10.16	11.87
S-204-A**	8.95	5.4	13.7	8.7	1.66	100.5	9.46	133	1.73E-04	4.24	11.72	15
S-206-A**	11.9	5.5	20.5	10.0	2.15	130.2	8.82	130	2.51E-04	4.24	13.28	16.3

\*Ratings assume water-cooling, continuously moving, 1 Liters/min. at 25C Water Temperature  
 \*\*Ratings assume water-cooling, continuously moving, 6 Liters/min. at 25C Water Temperature

S-404-A*	26.3	11.4	35.9	17.0	2.31	139.4	4.1	102	6.51E-04	5.24	13.68	25.9
S-406-A*	35.3	18.8	48.5	27.3	1.87	113.2	1.7	42	9.29E-04	5.24	15.78	31.7

\*Ratings assume water-cooling, continuously moving, 3 Liters/min. at 22C Water Temperature

S-604-A*	54.2	34.2	86.4	54.0	1.59	95.78	0.508	13.3	2.03E-03	6.33	16.61	45
S-606A-*	84.1	37.6	131.9	62.0	2.24	135.4	0.5	15.6	3.04E-03	6.33	19.31	55

### For More Information or to Order

Visit <https://www.kollmorgen.com/en-us/products/motors/servo/goldline-/goldline-s-series/goldline-s-series-submersible-servo-motors>

Australian Distributor for Kollmorgen



hello@motion-werkz.com  
 www.motion-werkz.com  
 Call us: 0499 885 772